



OPERATING MANUAL

REPLACING LINE TRIMMER HEAD

MODEL NUMBER AH1501

This Replacement Line Trimmer Head is exclusively compatible with EGO POWER+ Line Trimmer Attachment STA1500 & Brushcutter BC3800E & BC3802E.

DANGER: If the head loosens after it is fixed in position, replace it immediately. Never use a trimmer with a loose cutting attachment. Replace a cracked, damaged or worn-out cutting head immediately, even if damaged is limited to superficial cracks. Such attachments may shatter at high speed and cause serious injury.

WARNING: Always remove the battery pack from the product when you are assembling parts, making adjustments, cleaning, or when the product is not in use.

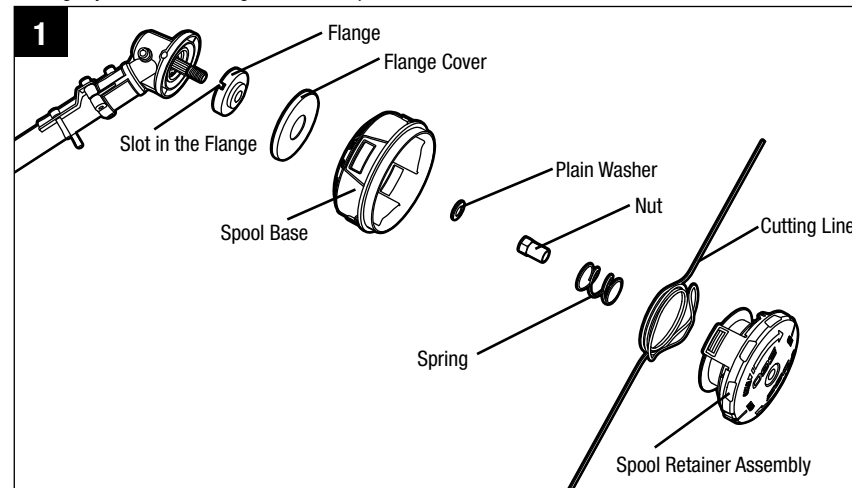

Remove the trimmer head

1. Remove the battery from the Power Head.
2. Press the 2 release tab on the spool retainer to remove it (Fig. 2 & 3).

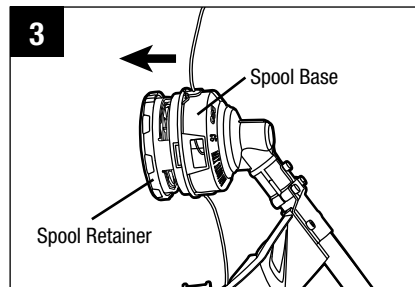
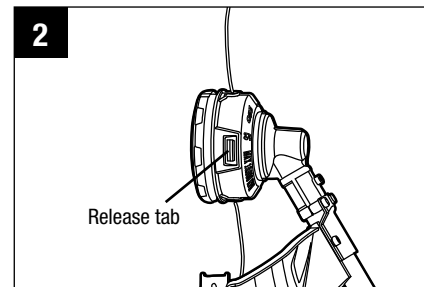

3. Pull the spring out of the spool base (Fig. 4).
4. Rotate the spool base to align the slot in the flange with the hole in the gear case (Fig. 5)

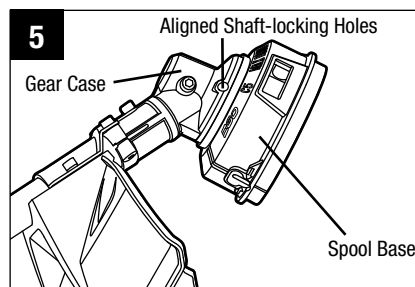
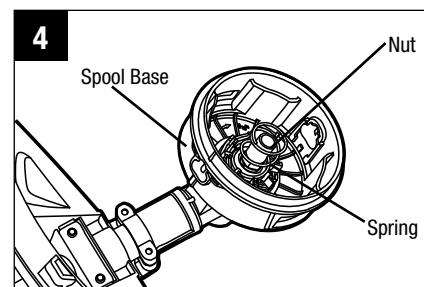

5. Insert a hex wrench with size less than 4mm into the aligned holes to act as a stabiliser (Fig.6). Use an impact socket wrench (15mm) to loosen the nut in the direction of the arrow marked on the spool base inside housing, and then remove it (Fig. 7).

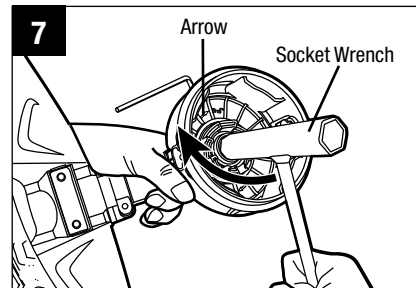
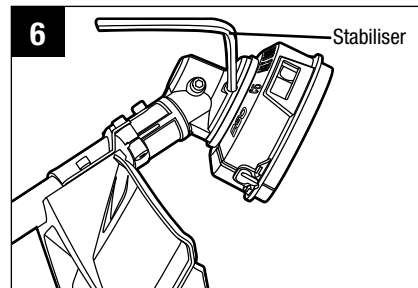

6. Remove the plain washer from the motor shaft and save it for reassembly (Fig. 8).
7. Hold the spool base and pull it straight out from the motor shaft (Fig. 9).

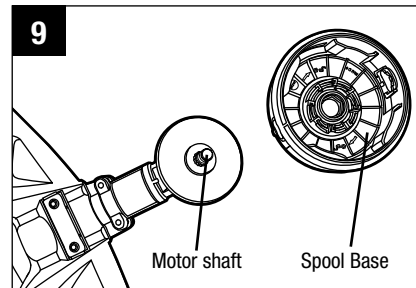
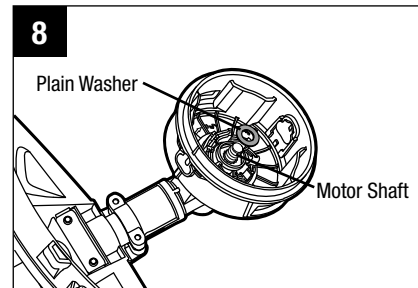

8. Remove the flange cover and then remove the flange from the motor shaft (Fig. 10). Check and replace them if they are worn.

Install the new trimmer head

1. Position the flange removed in step 8 of the "Remove the trimmer head" section onto the motor shaft with the bulge facing away from the base (Fig. 11).
2. Position the flange cover onto the flange with its flat surface facing outwards (Fig. 12).

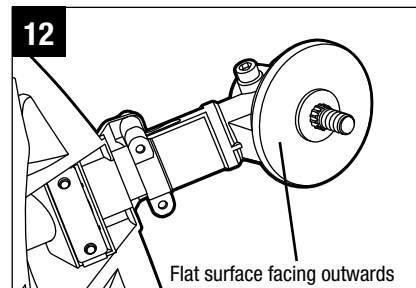
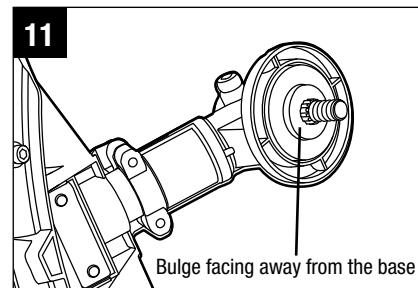

3. Align the mounting hole in the new spool base with the motor shaft, and then mount the new spool base onto the shaft.
4. Position the plain washer onto the motor shaft (Fig. 8).
5. Mount the nut onto the shaft, and pre-tighten it COUNTERCLOCKWISE by hand.
6. Rotate the spool base to align the slot in the flange with the hole in the gear case (Fig. 5).
7. Insert the hex wrench into the aligned holes to act as a stabiliser (Fig.6). Use the socket wrench to tighten the nut securely onto the shaft (Fig. 13).
8. Position the spring into the spool base and press it in place (Fig. 4).

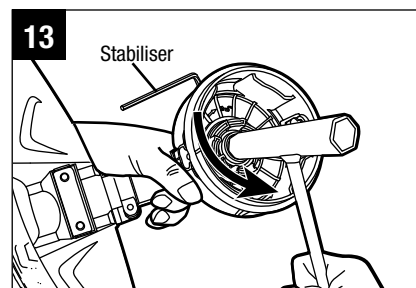

9. With one hand holding the spool base, use the other hand to grasp the new spool retainer and align the tabs on the new spool retainer with the holes in the spool base. Use your palm to press and rotate the new spool retainer left and right until the tabs lock with the spool base (Fig. 14 & 15).
10. If any parts of the spool retainer assembly are damaged or worn, replace the damaged part and reassemble them as following showing (Fig. 16).

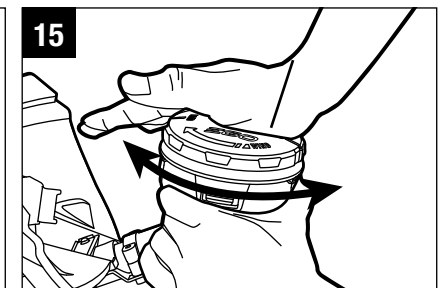
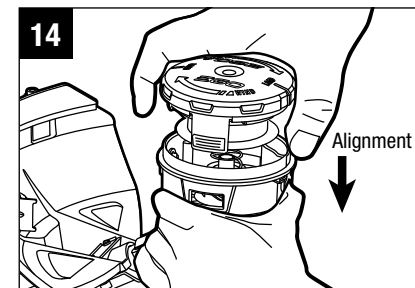

Wind the spool with new line

NOTICE: Always use the recommended nylon cutting line with a diameter that does not exceed 2.4mm. Using line other than that specified may cause the Line trimmer to overheat or become damaged.

WARNING: Never use metal-reinforced line, wire, or rope, etc. These can break off and become dangerous projectiles.

WARNING: To prevent serious personal injury, remove the battery pack from the power head before servicing, cleaning, changing attachments or removing material from the unit.

1. Remove the battery pack.
2. Remove the remaining cutting line, if necessary. Simply pull it out by hand.
3. Rotate the spool retainer in the direction indicated by the arrow, as necessary, to align the LOAD line on the spool retainer with the eyelets in the spool base (Fig. 17).
4. Cut one piece of cutting line 5m long. Insert the line into the mounting hole located inside the eyelet. Push the line until the end of the line comes out of the other side of the spool base. Pull the line from the other side until equal amounts of line appear on both sides of the spool (Fig. 18).
5. Press, while rotating the spool retainer in the direction indicated by the arrow in order to wind the cutting line onto the spool until approximately 14cm of line is showing on each side (Fig. 19).

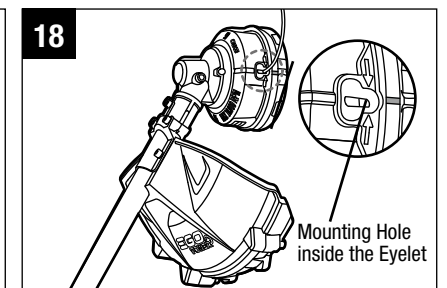
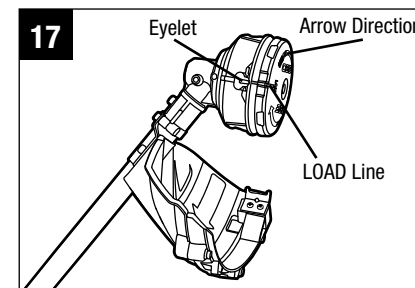

6. Push the spool retainer down while pulling on the lines to manually advance the line and to check for proper assembly of the trimmer head.

