

# EGO™

POWER<sup>+</sup> LINE TRIMMER

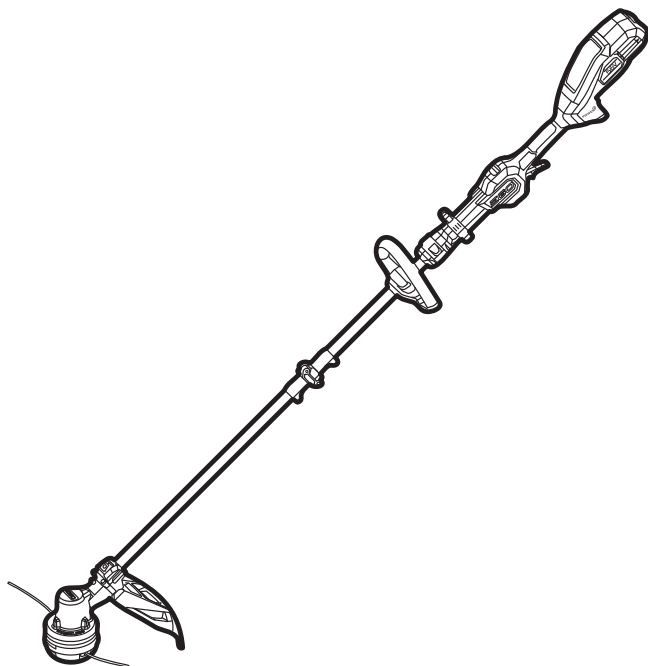

OPERATOR'S MANUAL

## 56 VOLT LITHIUM-ION CORDLESS LINE TRIMMER

MODEL NUMBER ST1610E-T

**⚠ WARNING:** To reduce the risk of injury, the user must read and understand the Operator's Manual before using this product. Save these instructions for future reference.

A

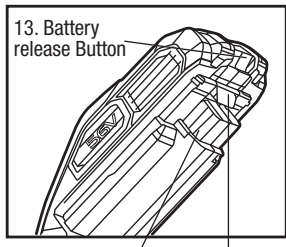
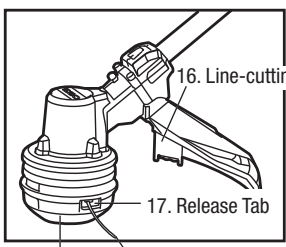
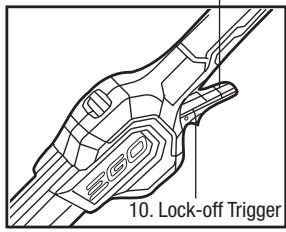
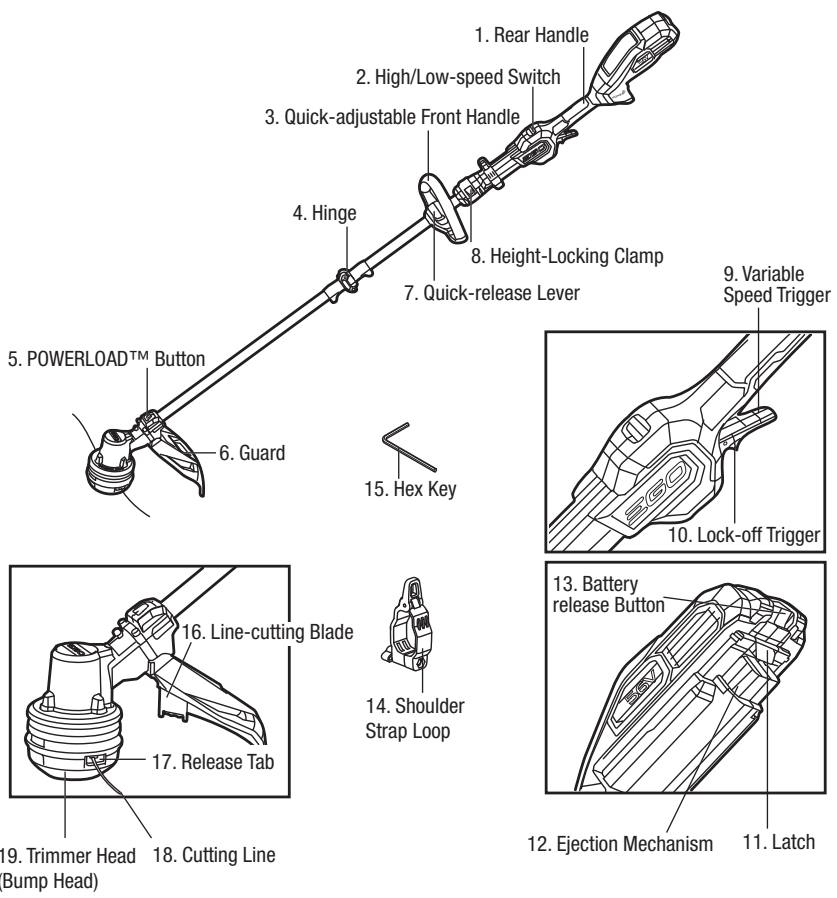

B1

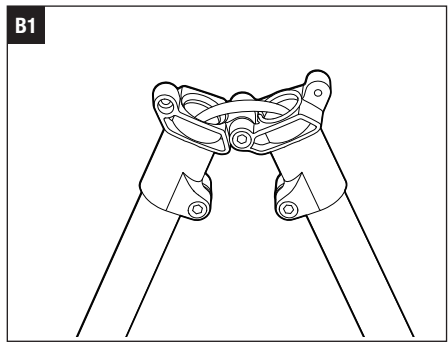

B2

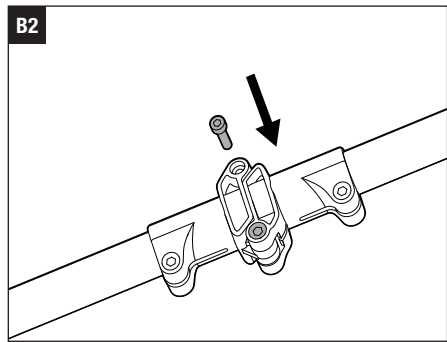

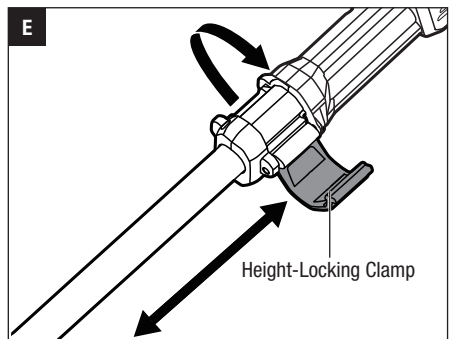
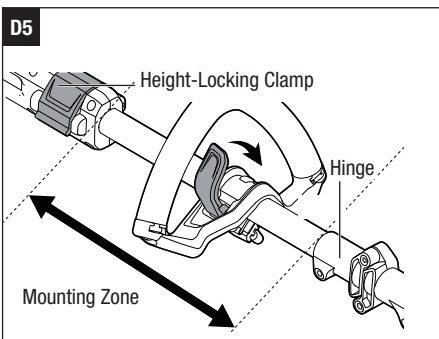
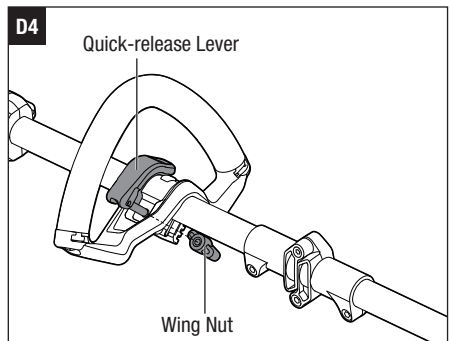
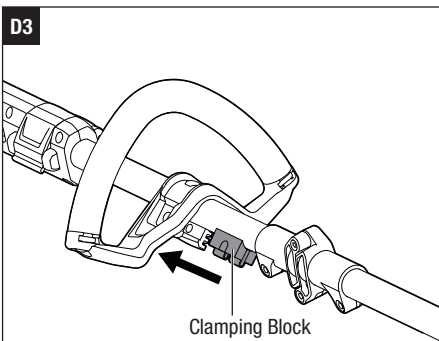
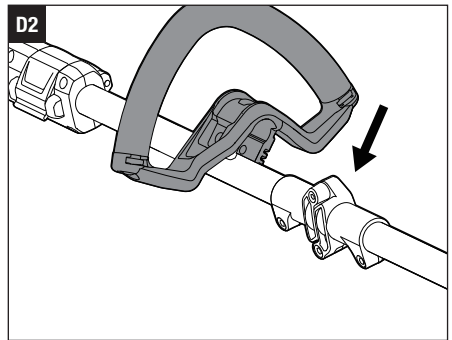
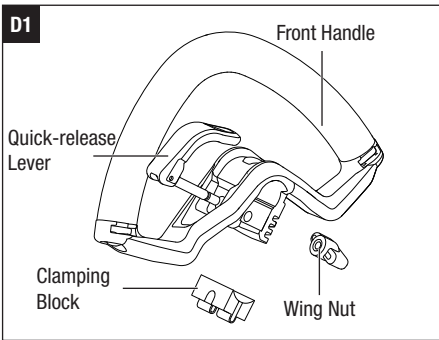
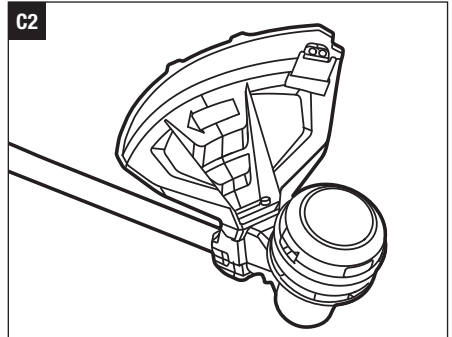
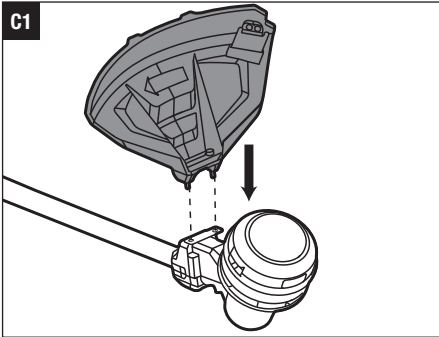

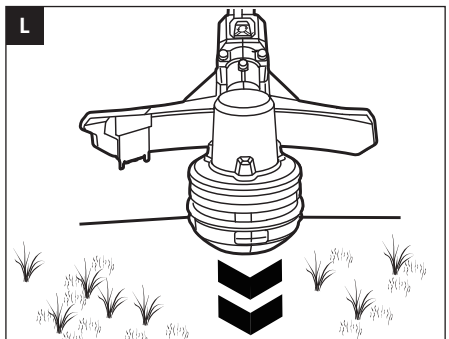
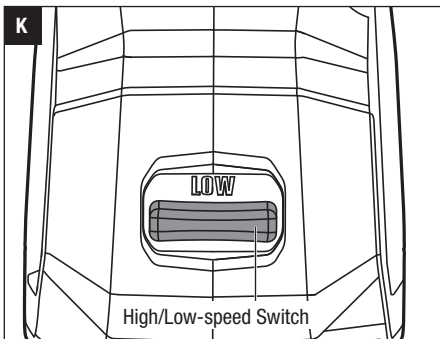
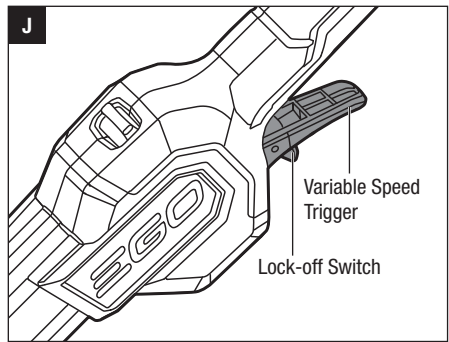
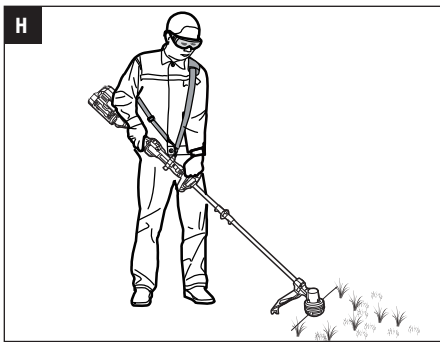
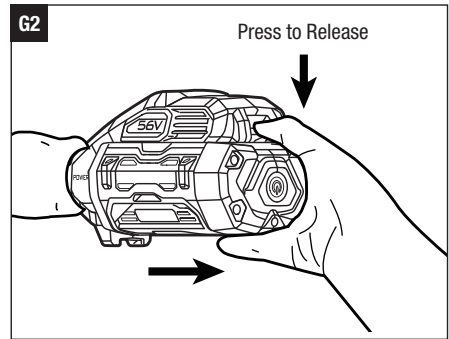
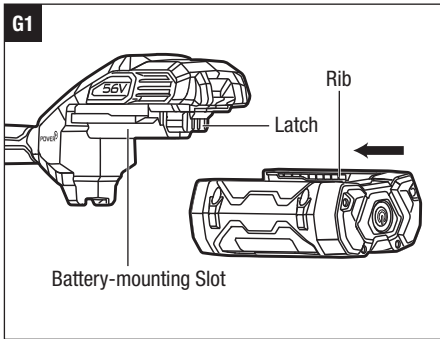
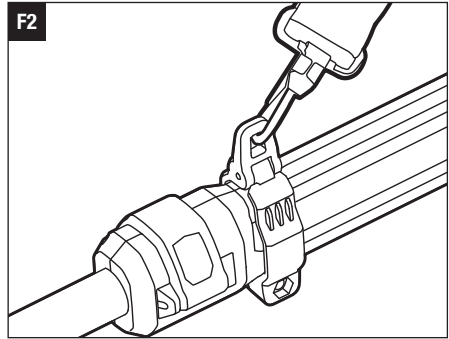
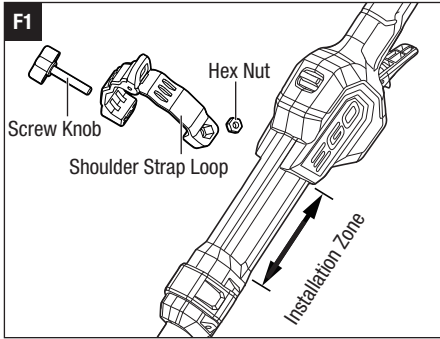

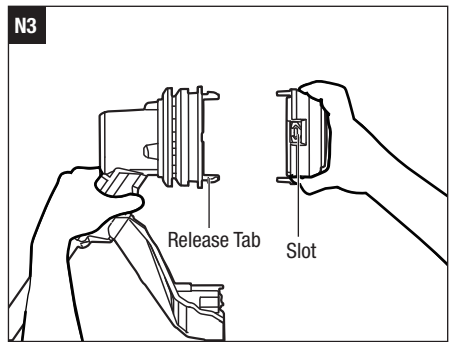
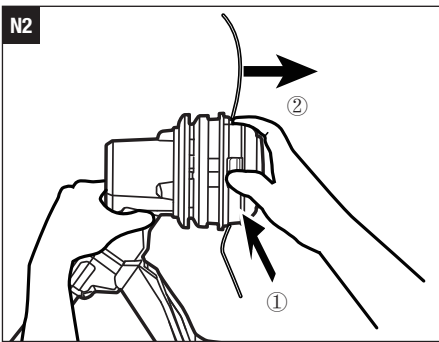
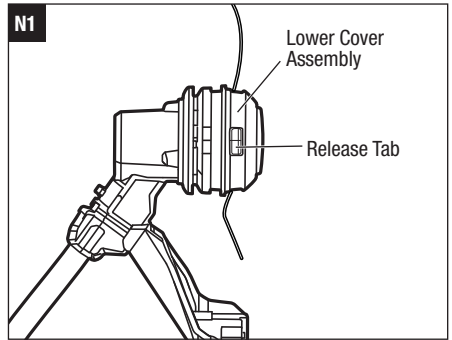
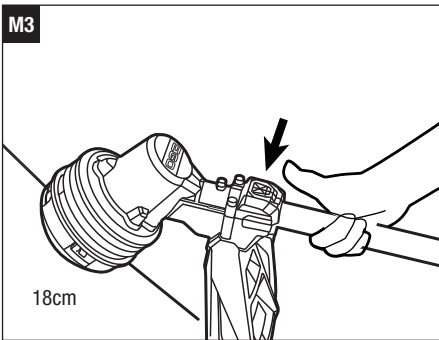
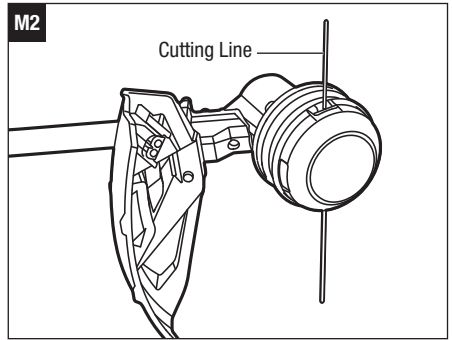
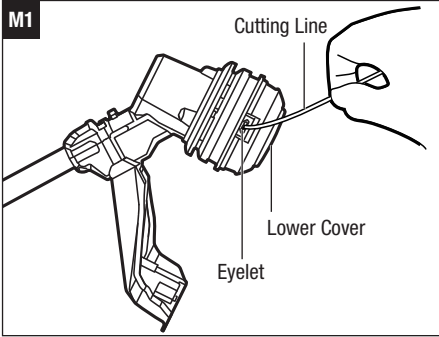

P1

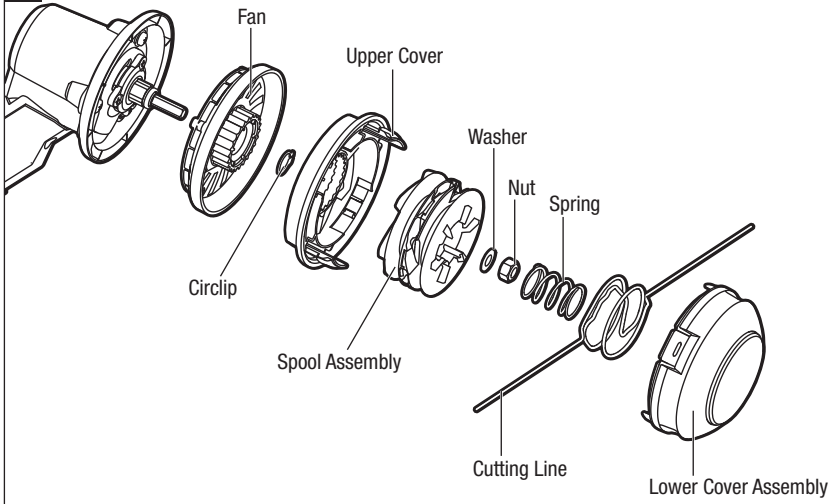

P2

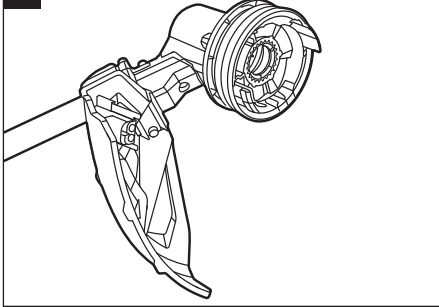

P3

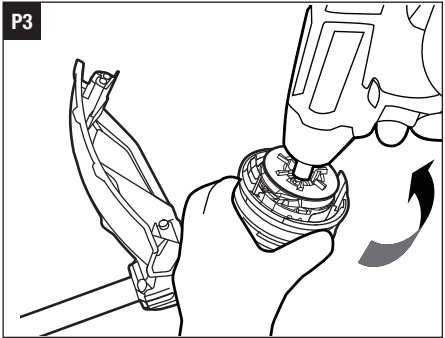

P4

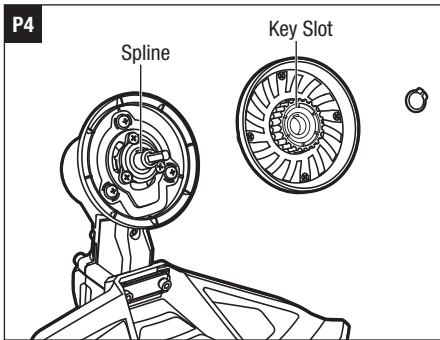

Q

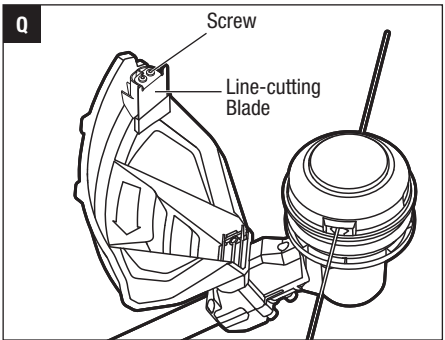

## READ ALL INSTRUCTIONS!



### READ OPERATOR'S MANUAL

**WARNING:** To ensure safety and reliability, all repairs should be performed by a qualified service technician.

## SAFETY SYMBOLS

The purpose of safety symbols is to attract your attention to possible dangers. The safety symbols and the explanations with them deserve your careful attention and understanding. The symbol warnings do not by themselves, eliminate any danger. The instructions and warnings they give are no substitutes for proper accident prevention measures.

**WARNING:** Be sure to read and understand all safety instructions in this Operator's Manual, including all safety alert symbols such as **"DANGER," "WARNING,"** and **"CAUTION"** before using this machine. Failure to follow all instructions listed below may result in electric shock, fire, and/or serious personal injury.

## SYMBOL MEANING

**SAFETY ALERT SYMBOL:** Indicates **DANGER, WARNING, or CAUTION.** May be used in conjunction with other symbols or pictographs.

## SAFETY INSTRUCTIONS

This page depicts and describes safety symbols that may appear on this product. Read, understand, and follow all instructions on the machine before attempting to assemble and operate.

	Safety Alert	Precautions that involve your safety.
	Read Operator's Manual	To reduce the risk of injury, user must read and understand operator's manual before using this product.
	Wear Eye Protection	Always wear safety goggles or safety glasses with side shields and a full face shield when operating this product.

	Wear Ear Protection	Always wear ear protection when operating this product.
	Noise	Guaranteed sound power level.
	WEEE	Waste electrical products should not be disposed of with household waste. Take to an authorized recycler.
	Regulatory Compliance Mark	This product complies with applicable Australian standards.
	Beware of thrown objects	Thrown objects can ricochet and result in personal injury or property damage. Ensure that other people and pets remain away from the line trimmer when it is in use.
	Keep safe distance	The distance between the machine and bystanders shall be at least 15m
	Do not use metal blades	Do not use the metal blades on the line trimmer
	Disconnect battery before maintenance	Disconnect the battery pack from the line trimmer
	Cutting width	The Max. cutting width of line trimmer
	Line diameter	The Diameter of the nylon cutting line
	Direct Current	Type or a characteristic of current
IPX4	Ingress Protection Degree	Protection from splashing water.
V	Volt	Voltage
n <sub>0</sub>	Maximum Speed	Maximum rotational speed

min <sup>-1</sup>	Revolutions or reciprocation per minute	Revolutions, strokes, surface speed orbits, etc. per minute
mm	Millimetre	Length or size
cm	Centimetre	Length or size
kg	Kilogram	Weight
°C	Degrees Celsius	Temperature

## GENERAL BATTERY-OPERATED MACHINE SAFETY WARNINGS

**⚠ WARNING:** Read all safety warnings, instructions, illustrations and specifications provided with this machine. Failure to follow all instructions listed below may result in electric shock, fire and/or serious injury.

### SAVE ALL WARNINGS AND INSTRUCTIONS FOR FUTURE REFERENCE.

The term “machine” in the warnings refers to your mains-operated (corded) machine or battery-operated (cordless) machine.

### WORK AREA SAFETY

- **Keep work area clean and well lit.** Cluttered or dark areas invite accidents.
- **Do not operate machines in explosive atmospheres, such as in the presence of flammable liquids, gases or dust.** Machines create sparks which may ignite the dust or fumes.
- **Keep children and bystanders away while operating a machine.** Distractions can cause you to lose control.

### ELECTRICAL SAFETY

- **Machine plugs must match the outlet. Never modify the plug in any way. Do not use any adapter plugs with earthed (grounded) machines.** Unmodified plugs and matching outlets will reduce risk of electric shock.
- **Avoid body contact with earthed or grounded surfaces, such as pipes, radiators, ranges and refrigerators.** There is an increased risk of electric shock if your body is earthed or grounded.
- **Do not operate the machine in rain or wet conditions.** Water entering the machine may increase the risk of electric shock or malfunction that could result in personal injury.

- **Do not abuse the cord. Never use the cord for carrying, pulling or unplugging the machine. Keep cord away from heat, oil, sharp edges or moving parts.** Damaged or entangled cords increase the risk of electric shock.
- **When operating a machine outdoors, use an extension cord suitable for outdoor use.** Use of a cord suitable for outdoor use reduces the risk of electric shock.
- **If operating a machine in a damp location is unavoidable, use a ground fault circuit interrupter (GFCI) protected supply.** Use of a GFCI reduces the risk of electric shock.

### PERSONAL SAFETY

- **Stay alert, watch what you are doing and use common sense when operating a machine. Do not use a machine while you are tired or under the influence of drugs, alcohol or medication.** A moment of inattention while operating machines may result in serious personal injury.
- **Use personal protective equipment. Always wear eye protection.** Protective equipment such as a dust mask, non-skid safety shoes, hard hat or hearing protection used for appropriate conditions will reduce personal injuries.
- **Prevent unintentional starting. Ensure the switch is in the off-position before connecting to power source and/or battery pack, picking up or carrying the machine.** Carrying machines with your finger on the switch or energizing machines that have the switch on invites accidents.
- **Remove any adjusting key or wrench before turning the machine on.** A wrench or a key left attached to a rotating part of the machine may result in personal injury.
- **Do not overreach. Keep proper footing and balance at all times.** This enables better control of the machine in unexpected situations.
- **Dress properly. Do not wear loose clothing or jewelry. Keep your hair and clothing away from moving parts.** Loose clothes, jewelry or long hair can be caught in moving parts.
- **If devices are provided for the connection of dust extraction and collection facilities, ensure these are connected and properly used.** Use of dust collection can reduce dust-related hazards.
- **Do not let familiarity gained from frequent use of machines allow you to become complacent and ignore machine safety principles.** A careless action can cause severe injury within a fraction of a second.

## MACHINE USE AND CARE

- **Do not force the machine. Use the correct machine for your application.** The correct machine will do the job better and safer at the rate for which it was designed.
- **Do not use the machine if the switch does not turn it on and off.** Any machine that cannot be controlled with the switch is dangerous and must be repaired.
- **Disconnect the plug from the power source and/or remove the battery pack, if detachable, from the machine before making any adjustments, changing accessories, or storing machines.** Such preventive safety measures reduce the risk of starting the machine accidentally.
- **Store idle machines out of the reach of children and do not allow persons unfamiliar with the machine or these instructions to operate the machine.** Machines are dangerous in the hands of untrained users.
- **Maintain machines and accessories. Check for misalignment or binding of moving parts, breakage of parts and any other condition that may affect the machine's operation. If damaged, have the machine repaired before use.** Many accidents are caused by poorly maintained machines.
- **Keep cutting machines sharp and clean.** Properly maintained cutting machines with sharp cutting edges are less likely to bind and are easier to control.
- **Use the machine, accessories and machine bits etc. in accordance with these instructions, taking into account the working conditions and the work to be performed.** Use of the machine for operations different from those intended could result in a hazardous situation.
- **Keep handles and grasping surfaces dry, clean and free from oil and grease.** Slippery handles and grasping surfaces do not allow for safe handling and control of the machine in unexpected situations.

## BATTERY MACHINE USE AND CARE

- **Recharge only with the charger specified by the manufacturer.** A charger that is suitable for one type of battery pack may create a risk of fire when used with another battery pack.
- **Use machines only with specifically designated battery packs.** Use of any other battery packs may create a risk of injury and fire.
- **When battery pack is not in use, keep it away from other metal objects, like paper clips, coins, keys, nails, screws or other small metal objects, that can make a connection from one terminal to another.**

Shorting the battery terminals together may cause burns or a fire.

- **Under abusive conditions, liquid may be ejected from the battery; avoid contact. If contact accidentally occurs, flush with water. If liquid contacts eyes, additionally seek medical help.** Liquid ejected from the battery may cause irritation or burns.
- **Do not use a battery pack or machine that is damaged or modified.** Damaged or modified batteries may exhibit unpredictable behavior resulting in fire, explosion or risk of injury.
- **Do not expose a battery pack or machine to fire or excessive temperature.** Exposure to fire or temperature above 130 °C may cause explosion.
- **Follow all charging instructions and do not charge the battery pack or machine outside the temperature range specified in the instructions.** Charging improperly or at temperatures outside the specified range may damage the battery and increase the risk of fire.

## SERVICE

- **Have your machine serviced by a qualified repair person using only identical replacement parts.** This will ensure that the safety of the machine is maintained.
- **Never service damaged battery packs.** Service of battery packs should only be performed by the manufacturer or authorized service providers.

## LINE TRIMMER SAFETY WARNINGS

- **Do not use the machine in bad weather conditions, especially when there is a risk of lightning.** This decreases the risk of being struck by lightning.
- **Thoroughly inspect the area for wildlife where the machine is to be used.** Wildlife may be injured by the machine during operation.
- **Thoroughly inspect the area where the machine is to be used and remove all stones, sticks, wires, bones, and other foreign objects.** Thrown objects can cause personal injury.
- **Before using the machine, always visually inspect to see that the cutter or blade and the cutter or blade assembly are not damaged.** Damaged parts increase the risk of injury.
- **Follow instructions for changing accessories.** Improperly tightened blade securing nuts or bolts may either damage the blade or result in it becoming detached.

- **Wear eye, ear, head and hand protection.** Adequate protective equipment will reduce personal injury by flying debris or accidental contact with the cutting line or blade.
- **While operating the machine, always wear non-slip and protective footwear. Do not operate the machine when barefoot or wearing open sandals.** This reduces the chance of injury to the feet from contact with the moving cutters or lines.
- **While operating the machine, always wear long trousers.** Exposed skin increases the likelihood of injury from thrown objects.
- **Keep bystanders away while operating the machine.** Thrown debris can result in serious personal injury.
- **Always use two hands when operating the machine.** Holding the machine with both hands will avoid loss of control.
- **Hold the machine by the insulated gripping surfaces only, because the cutting line or blade may contact hidden wiring.** Cutting line or blades contacting a “live” wire may make exposed metal parts of the machine “live” and could give the operator an electric shock
- **Always keep proper footing and operate the machine only when standing on the ground.** Slippery or unstable surfaces may cause a loss of balance or control of the machine.
- **Do not operate the machine on excessively steep slopes.** This reduces the risk of loss of control, slipping and falling which may result in personal injury.
- **When working on slopes, always be sure of your footing, always work across the face of slopes, never up or down and exercise extreme caution when changing direction.** This reduces the risk of loss of control, slipping and falling which may result in personal injury.
- **Keep all parts of the body away from the cutter, line or blade when the machine is operating. Before you start the machine, make sure the cutter, line or blade is not contacting anything.** A moment of inattention while operating the machine may result in injury to yourself or others.
- **Do not operate the machine above waist height.** This helps prevent unintended cutter or blade contact and enables better control of the machine in unexpected situations.
- **When cutting brush or saplings that are under tension, be alert for spring back.** When the tension in the wood fibers is released, the brush or sapling may strike the operator and/or throw the machine out of control.
- **Use extreme caution when cutting brush and saplings.** The slender material may catch the blade and be whipped toward you or pull you off balance.
- **Maintain control of the machine and do not touch cutters, lines or blades and other hazardous moving parts while they are still in motion.** This reduces the risk of injury from moving parts.
- **Carry the machine with the machine switched off and away from your body.** Proper handling of the machine will reduce the likelihood of accidental contact with a moving cutter, line or blade
- **Only use replacement cutters, lines, cutting heads and blades specified by the manufacturer.** Incorrect replacement parts may increase the risk of breakage and injury.
- **When clearing jammed material or servicing the machine, make sure the switch is off and the battery pack is removed.** Unexpected starting of the machine while clearing jammed material or servicing may result in serious personal injury.
- **Damage to Trimmer - If you strike a foreign object with the trimmer or it becomes entangled, stop the machine immediately, check for damage and have any damage repaired before further operation is attempted.** Do not operate with a broken guard or spool.
- **If the equipment should start to vibrate abnormally, stop the motor and check immediately for the cause. Vibration is generally a warning of trouble. A loose head may vibrate, crack, break or come off the trimmer, which may result in serious or fatal injury. Make sure that the cutting attachment is properly fixed in position. If the head loosens after fixing it in position, replace it immediately.** Never use a trimmer with a loose cutting attachment.
- **Use only with EGO's battery packs and chargers listed below:**

BATTERY PACK	CHARGER
BA1400, BA2800, BA4200, BA1400T, BA2800T, BA4200T, BA5600T, BA6720T	CH2100E CH5500E CH7000E CH7000E-T

**NOTE:** The machine must be used with EGO harness BH1001 when using the EGO Battery pack 7.5 Ah or higher capacity.

**SAVE THESE INSTRUCTIONS!**

## SPECIFICATIONS

Voltage	56V
No-load speed	Low: 4800/min
	High: 6000/min
Cutting Mechanism	Bump Head
Line-loading Mechanism	Motor Driven
Cutting Line Type	2.4 mm nylon twist line
Cutting Width	40 cm
Operating Temperature	0°C - 40°C
Storage Temperature	-20°C - 70°C
Guaranteed sound power level	95 dB(A)
Net Weight (without battery pack)	3.4 kg

## PACKING LIST

PART NAME	QUANTITY
Line Trimmer	1
Bolt for Locking shaft	1
Guard (with two screws preassembled on the guard)	1
Quick-adjustable Front Handle Assembly	1
Hex Key	1
Cutting Line	1
Shoulder Strap Loop	1
Operator's Manual	1

## DESCRIPTION

### KNOW YOUR LINE TRIMMER (Fig. A)

- Rear Handle
- High/Low-speed Switch
- Quick-Adjustable Front Handle
- Hinge
- POWERLOAD™ Button
- Guard
- Quick-release Lever
- Height-Locking Clamp
- Variable Speed Trigger
- Lock-off Trigger
- Latch
- Ejection Mechanism
- Battery release Button
- Shoulder Strap Loop
- Hex Key
- Line-cutting Blade
- Release Tab
- Cutting Line
- Trimmer Head (Bump Head)

## ASSEMBLY

**⚠ WARNING:** If any parts are damaged or missing, do not operate this product until the parts are replaced. Use of this product with damaged or missing parts could result in serious personal injury.

**⚠ WARNING:** Do not attempt to modify this product or create accessories not recommended for use with this line trimmer. Any such alteration or modification is misuse and could result in a hazardous condition leading to possibly serious personal injury.

**⚠ WARNING:** To prevent accidental starting that could cause serious personal injury, always remove the battery pack from the tool when assembling parts.

### UNFOLDING THE SHAFT

**⚠ WARNING:** In order to avoid pinching your hands or fingers, do not hold the shaft at the joint.

**⚠ WARNING:** Do not attempt to start the trimmer until the shaft has been locked.

Unfold the shaft gently, ensuring the cable inside the shaft and lock it with the bolt by the supplied wrench (Fig. B1 & B2).

**⚠ WARNING:** Always wear gloves when mounting or replacing the guard. Be careful of the blade on the guard and protect your hands from being injured by the blade.

**⚠ WARNING:** Never operate the machine without the guard firmly in place. The guard must always be on the machine to protect the user! When the guard is fixed, never attempt to remove or adjust the guard, if a replacement is needed, it should be performed by a qualified service technician!

Position your trimmer so that the trimmer head faces up (Fig. C1). Align the guard mounting holes with the assembly holes and then lock the guard on the shaft base with the two screws (Fig. C2).

**NOTICE:** Make sure the guard is fixed according to Fig. C1 & C2, any reverse fixing will cause great danger!

## MOUNTING AND ADJUSTING THE FRONT HANDLE

1. Loosen and remove the quick-release lever and wing nut from the front handle (Fig. D1).
2. Push the front handle onto the shaft within the mounting zone between the height locking collar and hinge (Fig. D2).
3. Insert the clamping block into the handle slot (Fig. D3).
4. Mount the quick-release lever and pre-tighten the wing nut. Make sure that the front handle is positioned upwards and points toward the top of the rear handle (Fig. D4).
5. Pull the quick-release lever up to move/rotate the front handle to a comfortable operating position, and then lock the quick-release lever (Fig. D5).

**NOTICE:** The front handle should be positioned on the shaft only within the mounting zone.

**⚠ WARNING:** The machine cannot be used without the front handle securely fixed.

## ADJUSTING THE TRIMMER HEIGHT

If the length of the shaft is not suitable for operation, you can adjust the length of the shaft through the height locking collar.

1. Remove the battery pack from the trimmer.
2. To adjust the trimmer height (i.e., shaft length), open the height locking collar, and then slide the shaft up or down to desired height, securing it in place by depressing the height locking collar (Fig. E).

**NOTICE:** The front handle may need to be repositioned after the trimmer height is changed.

## ATTACHING SHOULDER STRAP (SOLD SEPARATELY, MODEL NUMBER: AP1500)

For safe and better operation, put the strap over one of your shoulders and across your back.

1. Loosen screw knob and hex nut from the shoulder strap loop (Fig. F1).
2. Place the shoulder strap loop at a comfortable operating position within the installation zone, and then fix it by tightening the screw knob and hex nut.
3. Depress the shoulder strap carabineer to open it and attach the shoulder strap to the hole on the strap loop (Fig. F2).
4. Adjust the shoulder strap length and placement to a comfortable operating position.

**⚠ WARNING:** When an emergency occurs, take the shoulder strap off from your shoulder immediately, no matter what way the strap is on.

You should not use the single-shoulder strap and double-shoulder strap simultaneously.

When wearing the strap, make sure there is no other wearable interferes with the release and removal of the strap.

## OPERATION

**⚠ WARNING:** Always wear safety goggles or safety glasses with side shield, along with hearing protection. Failure to do so could result in objects being thrown into your eyes and other possible serious injuries.

**Trimming:** grass and weeds from around porches, fences, and decks.

**Cutting:** grass that is difficult to reach using a normal mower.

## ATTACHING/DETACHING THE BATTERY PACK

**Fully charge before first use.**

### To Attach

Align the battery ribs with the mounting slots and press the battery pack down until you hear a "click" (Fig. G1).

### To Detach

Depress the battery-release button and pull the battery pack out (Fig. G2).

## HOLDING THE LINE TRIMMER (FIG. H)

For safe and better operation, put on the shoulder strap across the shoulder. Adjust the shoulder strap length and placement to a comfortable operating position – hold the trimmer with both hands: one hand on the rear handle and the other hand on the front handle.

**NOTICE:** The trimmer head is parallel to the ground at a proper cutting distance without the operator bending over.

## STARTING/STOPPING THE LINE TRIMMER (FIG. J)

### To Start

Move the lock-off switch forward and then press the variable speed trigger.

The trigger is stepless speed adjusting. The more you pull up the trigger, the higher speed it is. Adjust the speed to suit the task at hand.

**NOTE:** The motor starts only when the lock-off switch is moved forward and the variable speed trigger is depressed at the same time.

### To Stop

Move the line trimmer away from the cutting area and release the variable speed trigger.

**⚠ WARNING:** Always remove the battery pack from the line trimmer during work breaks and after finishing work.

### SPEED ADJUSTMENT FUNCTION (FIG. K)

The line trimmer has two speed settings. Move the high/low speed switch forward or backward to choose the low or high speed.

### USING THE LINE TRIMMER

Clear the area to be cut before each use. Remove all objects, such as rocks, broken glass, nails, wire, or lien that can be thrown or become entangled in the cutting attachment. Clear the area of children, bystanders, and pets. At a minimum, keep all children, bystanders and pets at least 15 m away; there still may be risk to bystanders from thrown objects. Bystanders should be encouraged to wear eye protection. If you are approached, stop the motor and cutting attachment immediately.

### Before each use check for damaged/worn parts

Check the trimmer head, guard, shoulder strap, shoulder strap loop, and front handle. Replace any parts that are cracked, warped, bent, or damaged in any way.

The line-cutting blade on the edge of the guard can dull over time. It is recommended that you periodically sharpen it with a file or replace it with a new blade.

**⚠ WARNING:** Always wear gloves when mounting or replacing the guard or when sharpening or replacing the line-cutting blade. Note the location of the blade on the guard and protect your hands from injury.

### Check for blockage of the trimmer head

- To prevent blockage, keep the trimmer head clean. Remove grass clippings, leaves, dirt and any other accumulated debris before and after each use.
- When blockage happens, stop the line trimmer and remove the battery, then remove any grass that may have wrapped itself around the motor shaft or trimmer head.

**After each use, clean the trimmer.**

### ADJUSTING THE CUTTING LINE LENGTH (FIG. L)

The trimmer head allows the operator to release more cutting line without stopping the motor. As line becomes frayed or worn, additional line can be released by lightly tapping the trimmer head on the ground while operating the trimmer.

**⚠ WARNING:** Do not remove or alter the line cutting blade assembly. Excessive line length will cause the motor to overheat and may result in serious personal injury.

For best results, tap the trimmer head on bare ground or hard soil. If line release is attempted in tall grass, the motor may overheat. Always keep the trimming line fully extended. Line release becomes more difficult as the cutting line becomes shorter.

### LINE REPLACEMENT

**NOTICE:** Always use the recommended nylon cutting line with a diameter of 2.4 mm.

Using line other than that specified may cause the machine to overheat or become damaged.

**⚠ WARNING:** Never use metal-reinforced line, wire, or rope, etc. These can break off and become dangerous projectiles.

The line trimmer is equipped with an advanced POWERLOAD™ system. The cutting line can be wound onto the spool simply by pressing a single button. Loading a full spool can usually be completed in 12 seconds. Avoid repeated operation of the winding system in rapid succession to reduce the possibility of motor damage.

1. Remove the battery pack.
2. Cut one piece of cutting line 4 m long.
3. Insert the line into the eyelet and push the line until the end of the line comes out of the opposite eyelet (Fig. M1).

**NOTICE:** It is not necessary to align the eyelets in order to insert the cutting line. If the line cannot be inserted into the eyelet, mount the battery pack onto the trimmer, then press the POWERLOAD™ button briefly to reset the winding mechanism.

4. Remove the battery pack if it has been mounted onto the trimmer in step 3.
5. Pull the line from the other side until equal lengths of the line appear on both sides of the trimmer head (Fig. M2).

6. Install the battery pack onto the line trimmer.
  7. Press and hold the POWERLOAD™ button to start the line-winding motor. The line will be wound into the trimmer head continuously.
  8. Watch the remaining line length carefully. Prepare to release the button as soon as approximately 22 cm of line are left on each side. Briefly press the line loading button to adjust the length until 18 cm of the line is showing on each side (Fig. M3).
3. Remove the cutting line from the trimmer head (Fig. P2).
  4. Wear gloves. Use one hand to grasp the spool assembly to stabilize it, and use the other hand to hold a 13 mm impact wrench (not included) to loosen the nut in a counterclockwise direction (Fig. P3).
  5. Remove the nut, washer, spool assembly and upper cover from the motor shaft.
  6. Use circlip pliers (not included) to remove the circlip. Remove the fan.
  7. Replace with a new trimmer head and mount it according to following steps.

**NOTICE:** In case the line is pulled into the trimmer head by accident, open the head and pull the cutting line out from the spool. Follow the section “**RELOADING THE CUTTING LINE**” in this manual to reload the line.

## RELOADING THE CUTTING LINE

**NOTICE:** When the cutting line gets stuck in the trimmer head, you will need to remove the remaining cutting line from the trimmer head and follow the steps below to reload the line.

1. Remove the battery pack.
2. Press the release tabs on the trimmer head and remove the lower cover assembly of the trimmer head by pulling it straight out (Fig. N1 & N2).
3. Remove the cutting line from the trimmer head.
4. With one hand holding the trimmer, use another hand to grasp the lower cover assembly and align the slots in the lower cover assembly with the release tabs. Press the lower cover assembly until it snaps into place, at which time you will hear a distinct click sound (Fig. N3).
5. Follow the instructions in the “**LINE REPLACEMENT**” section to reload the cutting line.

## TRIMMER HEAD REPLACEMENT

**⚠ DANGER:** If the head loosens after it is fixed in position, replace it immediately. Never use a trimmer with a loose cutting attachment. Replace a cracked, damaged or worn out cutting head immediately, even if damage is limited to superficial cracks. Such attachments may shatter at high speed and cause serious injury.

### Know the trimmer head (Fig. P1)

#### Remove the trimmer head

1. Remove the battery pack from the trimmer.
2. Press the release tabs on the trimmer head and remove the lower cover assembly of the trimmer head by pulling it straight out (Fig. N1 & N2).

3. Remove the cutting line from the trimmer head (Fig. P2).
4. Wear gloves. Use one hand to grasp the spool assembly to stabilize it, and use the other hand to hold a 13 mm impact wrench (not included) to loosen the nut in a counterclockwise direction (Fig. P3).
5. Remove the nut, washer, spool assembly and upper cover from the motor shaft.
6. Use circlip pliers (not included) to remove the circlip. Remove the fan.
7. Replace with a new trimmer head and mount it according to following steps.

#### Install the new trimmer head

1. Align the key slot in the fan assembly with the spline in motor shaft and mount the fan assembly into place (Fig. P4).
2. Mount the circlip, upper cover, spool assembly, and washer in that order. Use an impact wrench on the nut to tighten it.
3. Mount the lower cover assembly.
4. Reload the cutting line.
5. Start the machine to see whether the line trimmer will work normally. If it does not, reassemble as described above.

## MAINTENANCE

**⚠ WARNING:** When servicing, use only identical replacement parts. Use of any other parts may create a hazard or cause product damage. To ensure safety and reliability, all repairs should be performed by a qualified service technician.

**⚠ WARNING:** To prevent serious personal injury, remove the battery pack from the machine before servicing, cleaning, or removing material from the unit.

**⚠ CAUTION:** Obstructions in the vents will prevent the air from flowing into the motor housing and result in overheating or damaged of the motor.

#### CLEANING THE UNIT

- Clean the unit using a damp cloth with a mild detergent. Never let any liquid get inside the machine; never immerse any part of the machine into a liquid.
- Do not use any strong detergents on the plastic housing or the handle. They can be damaged by certain aromatic oils, such as pine and lemon, and by solvents such as kerosene. Moisture can also cause a shock hazard. Wipe off any moisture with a soft, dry cloth.

- Use a small brush or the air discharge of a small vacuum cleaner brush to clean the air vents on the rear housing.
- Keep the air vents free of obstructions.

### SHARPENING THE LINE-CUTTING BLADE

**⚠ WARNING:** Always protect your hands by wearing heavy gloves when performing any maintenance on the line-cutting blade.

1. Loosen the two screws and remove the line-cutting blade from the guard (Fig. Q).
2. Secure the blade in a vise.
3. Carefully file the cutting edges of the blade with a fine-tooth file or sharpening stone, being careful to maintain the original cutting-edge angle.
4. Replace the blade onto the guard and secure it in place with the two screws.

### STORING THE UNIT

- Remove the battery pack from the trimmer.
- Clean the machine thoroughly before storing.
- Store the unit in a dry, well-ventilated area, locked-up or up high, out of the reach of the children. Do not store the unit on or adjacent to fertilizers, gasoline, or other chemicals.

### Protecting the environment



Do not dispose of electrical equipment, used battery and charger into household waste! Take this product to an authorized recycler and make it available for separate collection. Electric tools must be returned to an environmentally compatible recycling facility.

## TROUBLESHOOTING

PROBLEM	CAUSE	SOLUTION
Line trimmer fails to start	<ul style="list-style-type: none"> <li>■ The battery pack is not attached to the trimmer.</li> <li>■ No electrical contact between the trimmer and battery.</li> <li>■ The battery pack is depleted.</li> <li>■ The lock off switch is not being moved forward before depressing the variable speed trigger.</li> <li>■ The motor shaft or trimmer head is bound with grass.</li> </ul>	<ul style="list-style-type: none"> <li>■ Attach the battery pack to the trimmer.</li> <li>■ Remove battery, check contacts and reinstall the battery pack.</li> <li>■ Charge the battery pack.</li> <li>■ Move the lock-off switch forward and then press the variable speed trigger.</li> <li>■ Remove the grass from the motor shaft and trimmer head.</li> </ul>
Line trimmer stops while cutting.	<ul style="list-style-type: none"> <li>■ The guard is not mounted on the trimmer, resulting in an overly long cutting line and motor overload.</li> <li>■ Heavy cutting line is used.</li> <li>■ The battery pack or line trimmer is too hot.</li> <li>■ The battery pack is disconnected from the machine.</li> <li>■ The battery pack is depleted.</li> </ul>	<ul style="list-style-type: none"> <li>■ Remove the battery pack and mount the guard on the trimmer.</li> <li>■ Use recommended nylon cutting line with diameter 2.4 mm.</li> <li>■ Cool the battery or line trimmer.</li> <li>■ Re-install the battery pack.</li> <li>■ Charge the battery pack.</li> </ul>
Trimmer head will not advance line.	<ul style="list-style-type: none"> <li>■ The motor shaft or trimmer head is bound with grass.</li> <li>■ There is not enough line on the spool or the line breaks from the eyelet.</li> <li>■ The line is tangled.</li> <li>■ The line is too short.</li> <li>■ Heavy cutting line is used.</li> <li>■ Trimmer head malfunction.</li> </ul>	<ul style="list-style-type: none"> <li>■ Stop the trimmer, remove the battery, and clean the motor shaft and trimmer head.</li> <li>■ Remove the battery and replace the cutting line follow “<b>LINE REPLACEMENT</b>” section in this manual.</li> <li>■ Remove the battery; remove the line from the trimmer head and rewind following “<b>RELOAD THE CUTTING LINE</b>” section in this manual.</li> <li>■ Remove the battery and pull the lines manually while alternately pressing down and releasing the trimmer head.</li> <li>■ Use recommended nylon cutting line with diameter 2.4 mm.</li> <li>■ Call EGO Customer Service for help.</li> </ul>
Trimmer head continues to release line automatically.	<ul style="list-style-type: none"> <li>■ Light cutting line is used.</li> </ul>	<ul style="list-style-type: none"> <li>■ Use recommended nylon cutting line with diameter 2.4 mm.</li> </ul>
Grass is wrapped around trimmer head and motor housing.	<ul style="list-style-type: none"> <li>■ Cutting tall grass at ground level</li> </ul>	<ul style="list-style-type: none"> <li>■ Cut tall grass from the top down, removing no more than 20 cm in each pass to prevent wrapping.</li> </ul>
The blade is not cutting the line.	<ul style="list-style-type: none"> <li>■ The line-cutting blade on the edge of the guard has become dull.</li> </ul>	<ul style="list-style-type: none"> <li>■ Follow instructions to sharpen the line-cutting blade with a file or replace it with a new blade.</li> </ul>

PROBLEM	CAUSE	SOLUTION
Cracks on the trimmer head	<ul style="list-style-type: none"> <li>■ The trimmer head is worn out.</li> </ul>	<ul style="list-style-type: none"> <li>■ Replace the trimmer head immediately follow the section "TRIMMER HEAD REPLACEMENT" in this manual.</li> </ul>
Replace the trimmer head immediately following "TRIMMER HEAD REPLACEMENT" in this manual.	<ul style="list-style-type: none"> <li>■ Improper cutting line is used.</li> <li>■ Grass debris or dirt has accumulated in the trimmer head and blocked the movement of line spool.</li> <li>■ Motor is overheated due to repeatedly operating the line winding system.</li> <li>■ Low battery capacity.</li> <li>■ The line is not wound into the spool assembly.</li> <li>■ Trimmer head is defective.</li> </ul>	<ul style="list-style-type: none"> <li>■ We suggest that you use EGO original nylon cutting line. If using EGO nylon line and the problem persists, please call EGO customer service for advice.</li> <li>■ Remove the battery, open the trimmer head and clean it thoroughly.</li> <li>■ Let the line trimmer work under no load for a few minutes to cool the motor, then try to reload the line.</li> <li>■ Charge the battery.</li> <li>■ Pull out the line and reinsert it.</li> <li>■ Call EGO Customer Service for help.</li> </ul>
The cutting line cannot be passed through the trimmer head when inserting the line.	<ul style="list-style-type: none"> <li>■ The cutting line is split or bent at the end.</li> </ul>	<ul style="list-style-type: none"> <li>■ Cut the worn end of line and reinsert.</li> </ul>

## WARRANTY

### EGO WARRANTY POLICY

For full warranty terms and conditions, warranty service or to make a claim, please visit our website [egopowerplus.com.au/warranty-policy](http://egopowerplus.com.au/warranty-policy).

Also see full warranty details & warranty table on the 'NEED HELP?' flyer contained within this product.

Alternatively you can contact EGO customer service via the following:

#### Australia

Address: Chervon Australia Pty Ltd, Unit 14, 5 Kelletts Rd, Rowville, VIC, 3178.

Phone: 1300 000 346

Email: [support@egopowerplus.com.au](mailto:support@egopowerplus.com.au)

#### New Zealand

Address: Chervon New Zealand Subsidiary Ltd, 4th Floor, Smith & Caughey Building, 253 Queen St, Auckland, 1141.

Phone: 0508 000 346

Email: [support@egopowerplus.co.nz](mailto:support@egopowerplus.co.nz)





